

Phase II

DDTCP (CR) APPROVAL NO. 72/2012 FOR HOUSING SITES AT VATTAMBAKKAM VILLAGE, SRIPERUMBUDUR TALUK, KANCHIPURAM DISTRICT IN SURVEY NOS. 1,2/1

Area Statement Phase II

1	5110	45	600	85	1500	128	1500
2	2392	46	600	86	1500	129	1500
3	2318	46A	645	87	1500	130	1500
4	2242	47A	720	88	1500	131	1987
5	2167	47	600	89	1500	132	1987
6	2093	48	600	90	1987	133	1500
7	2017	49	600	91A	1140	134	1500
8	1935	50	587	91	600	135	1500
9	2467	51	587	92	600	136	1500
10	2387	52	600	93	600	137	1500
11	1800	53	600	94	600	138	1500
12	1800	54	600	95	600	139	1500
13	1800	54A	765	96	600	140	3525
14	1800	55A	945	97	600	141	1925
15	1800	55	600	98	600	142	2500
16	1800	56	600	99	600	143	3490
17	1800	57	600	100	600	144	3720
18	4095	58	587	101	600	145	1787
19	2362	59	587	102	600	146	1800
20	1500	60	600	103	600	147	2430
21	1500	61	600	104	600	148	1947
22	1500	62	600	105	587	149	1473
23	1500	62A	840	106	600	150	1897
24	1500	63	1987	107	587	151	1897
25	1500	64	1500	108	600	152	1473
26	1500	65	1500	109	600	153	2223
27	1500	66	1500	110	600	154	2819
28	1987	67	1500	111	600	155	1650
29	1987	68	1500	112	600	156	2187
30	1500	69	1737	113	600	157	2187
31	1500	70	1737	114	600	158	1650
32	1500	71	1500	115	600	159	1650
33	1500	72	1500	116	600	160	1526
34	1500	73	1500	117	600		
35	1500	74	1500	118	600		
36	1500	75	1500	119	600		
37	1500	76	1987	120	600		
38	2587	77	1987	121	600		
39A	510	78	1500	121A	960		
39	600	79	1500	122	2500		
40	600	80	1500	123	1500		
41	600	81	1500	124	1500		
42	587	82	1500	125	1500		
43	587	83	1737	126	1500		
44	600	84	1737	127	1500		

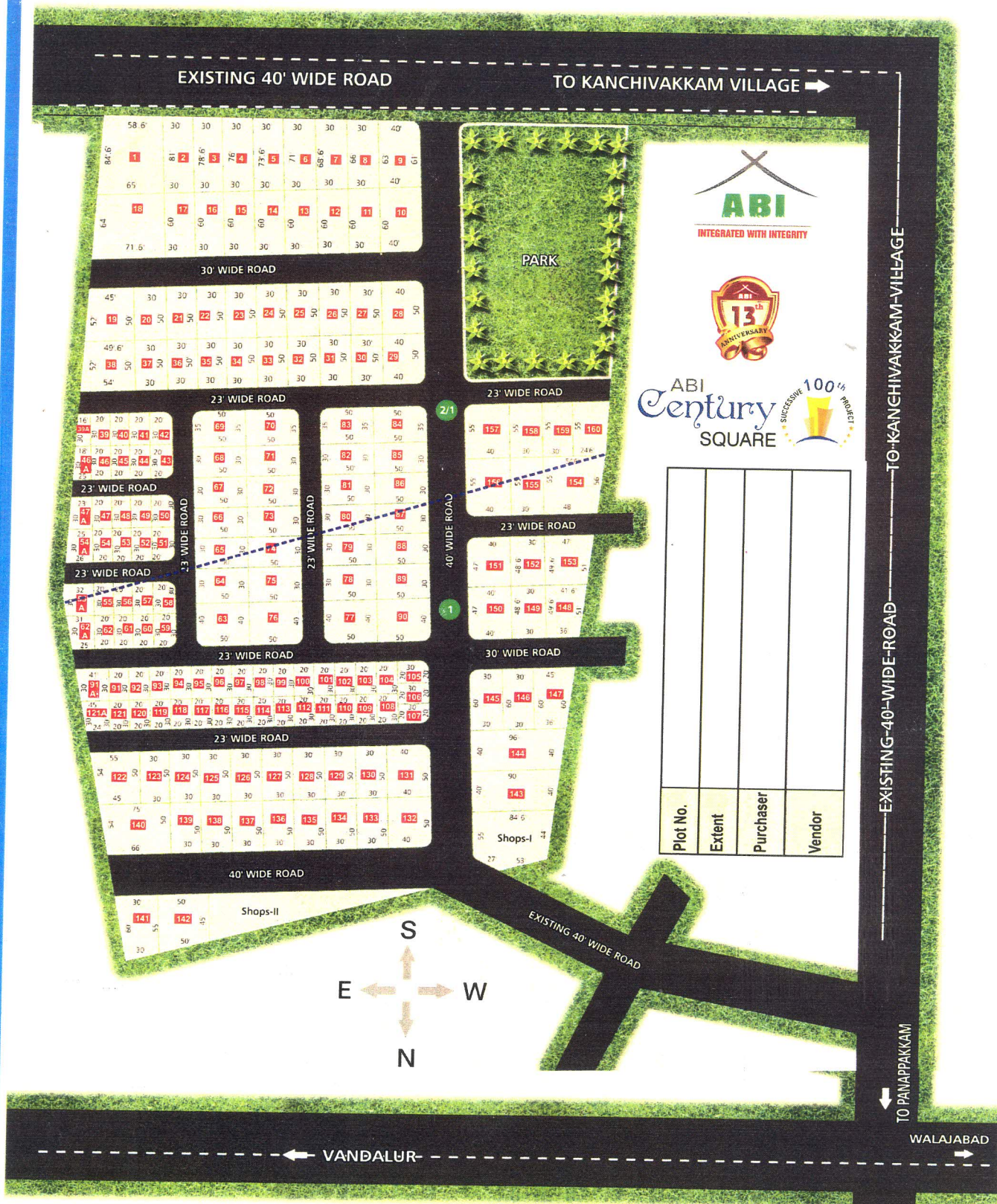

ABI
Century
SQUARE



Plot No.	Extent	Purchaser	Vendor

EXISTING 40'-WIDE ROAD

TO PANIAPPAKKAM

WALAJABAD